

WINFLASH™

WINDOW AND DOOR FLASHING MEMBRANE

FROM W. R. MEADOWS

DESCRIPTION

WINFLASH is a self-adhering, flexible membrane flashing tape which is nominally 20 mils thick. When properly applied, the product acts as a moisture barrier and reduces the risk of rot and mold development.

USES

WINFLASH provides protection against water infiltration in critical detail areas, such as window and door openings, deck-to-wall intersections, corner boards, wall-to-wall tie-ins, foundation sill plates, sheathing panel seams, under stucco finishes, masonry walls, and other non-roof detail areas.

FEATURES/BENEFITS

- Specifically formulated to block the ingress of moisture into the home environment.
- Self-adhering - easy application with hand roller.
- Multiple widths available to meet stringent moisture protection demands.
- Membrane is flexible – will remain in place during period of movement.
- Self sealing.
- Superior adhesion.

PACKAGING

ROLL SIZES

4" x 100'	6" x 100'	9" x 100'	12" x 100'	18" x 100'
-----------	-----------	-----------	------------	------------

APPLICATION

SURFACE PREPARATION Apply **WINFLASH** in fair weather conditions when the air, surface, and membrane are at temperatures of 40° F or higher. Install directly onto a clean and dry surface. Remove dust, dirt, and loose nails. Protrusions must be removed. Surfaces should have no voids or damaged/unsupported areas. Repair surfaces before installing. Surfaces should be free of scale, rust, grease, and oil.

APPLICATION METHOD Cut **WINFLASH** to desired length. Peel back the release paper to expose adhesive. Align the membrane and roll press into place with heavy pressure. Laps must be a minimum of 3" (75 mm). Consistent with good construction practice, install the membrane so that all laps shed water (following the shingle principle). The top membrane layer should go over the bottom layer. Always work from low point to high point. Test adhesion – if extra adhesion is required, apply MEL-PRIME™ or MEL-PRIME W/B from W. R. MEADOWS.



W. R. MEADOWS, INC. | P.O. Box 338 | HAMPSHIRE, IL 60140-0338
Phone: 847/214-2100 | Fax: 847/683-4544 | www.wrmeadows.com

WINFLASH™

WINDOW AND DOOR FLASHING MEMBRANE

FROM W. R. MEADOWS

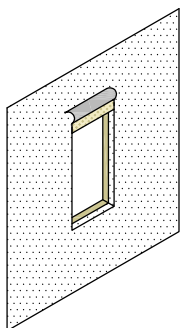

Fold up the weather-resistive barrier (WRB) at the header of the rough opening.

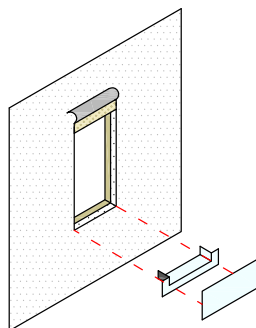

Cut WINFLASH approximately 12" longer than the width of the rough opening. Remove the release paper from the back of the WINFLASH and adhere it to the face of the wall. Cut the edges of the WINFLASH and fold into the rough opening and roll press into place. The WINFLASH should fully extend to the backside of the sill and 6" up either side of the jamb.

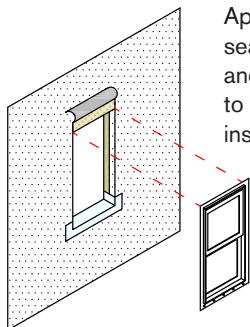

Apply a continuous bead of sealant around the rough opening and install the window according to window manufacturer's instructions.

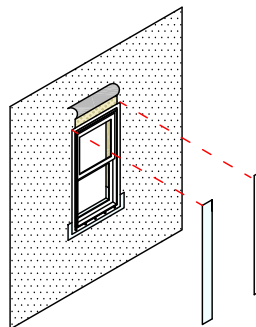

Install two pieces of WINFLASH to either side of the rough opening following window installation. Apply WINFLASH fully over the flange of the window and extend the flashing a minimum of 3" out onto the face of the wall. Roll press into place.

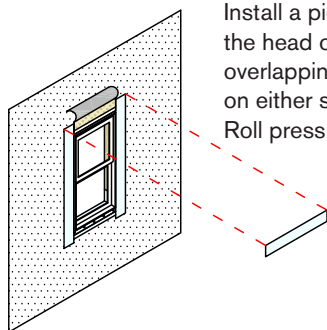

Install a piece of WINFLASH at the head of the rough opening overlapping the strips of WINFLASH on either side of the rough opening. Roll press into place.

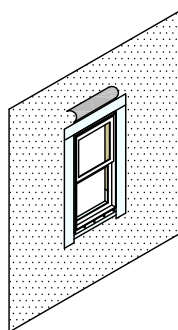

Fold down and secure the unattached WRB.

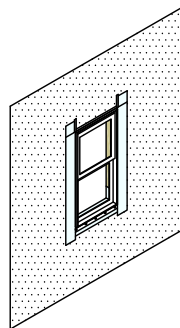

Using manufacturer recommended seaming tape and roll press into place. Ensure all seams and joints have been taped.

WARRANTY:

From 10 years of purchase, W. R. MEADOWS, INC. will replace any defective material exhibiting signs of moisture intrusion. W. R. MEADOWS is not responsible for any collateral damages due to this moisture penetration; only material replacement.